

# C-Band Radar - GaN Internally Pre-matched Discrete



**IGN5259M20**  
**IGN5259M20S**

Integra introduces the IGN5259M20 – an internally pre-matched discrete device based on gold metalized GaN technology.

- Output Power:  $\geq 20\text{W}$
- Gain: 12dB typ
- Efficiency:  $\geq 60\%$  typ
- Also available in flangeless “S” package
- Frequency: 5.2-5.9GHz, PW = 300 $\mu\text{s}$ , DF = 10%
- $V_{\text{DD}} = 36\text{V}$ ,  $I_{\text{DQ}} = 20\text{mA}$

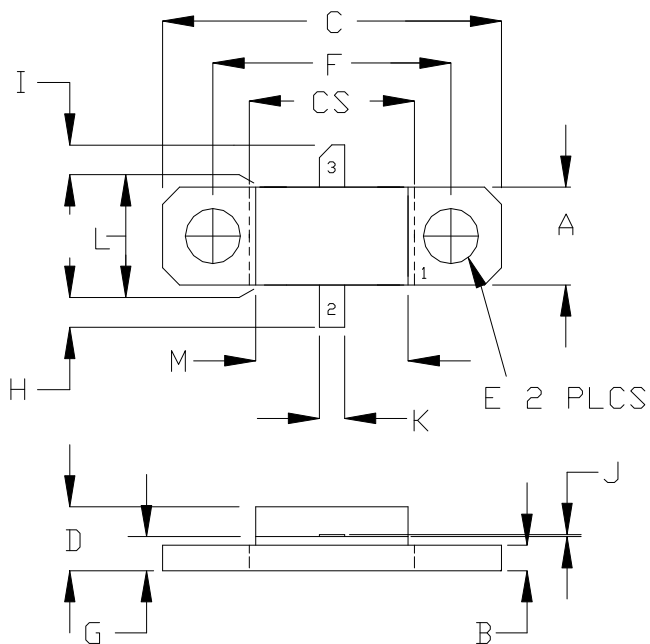

'S' VERSION USE DIM CS  
NON 'S' VERSION USE DIM C

DIM	INCHES		MILLIMETERS	
	MIN	MAX	MIN	MAX
A	0.225	0.235	5.71	5.96
B	0.055	0.065	1.40	1.65
C	0.795	0.805	20.19	20.44
CS	0.385	0.395	9.78	10.03
D	0.140	0.160	3.55	4.06
E	0.125	0.135	3.18	3.43
F	0.557	0.567	14.14	14.40
G	0.077	0.087	1.95	2.20
H	0.093	0.107	2.36	2.72
I	0.093	0.107	2.36	2.72
J	0.004	0.006	0.10	0.15
K	0.055	0.065	1.40	1.65
L	0.225	0.235	5.71	5.96
M	0.355	0.365	9.01	9.27

PIN SCHEDULE	
1	SOURCE
2	GATE
3	DRAIN



IGN5259M20-IGN5259M20S-PR1-NPS-NC  
Available Now

[www.integrattech.com](http://www.integrattech.com)